

ISTRIA ADRIA
Pot za Brdom 102, 1000 Ljubljana
e-mail: info@istria-adria.com
web: istria-adria.com
info: +386 59 200 071



| | |
|-------------------------------|----------------------|
| Code : | 10464 |
| Location : | Pula |
| Building size : | 80.16 m ² |
| Garden size : | 0.00 m ² |
| Distance from center : | 1000 m |
| Distance from sea : | 1000 m |
| Floor : | 2 |
| Number of floors : | 4 |
| Number of bedrooms : | 2 |
| Number of rooms : | 2 |
| Number of bathrooms : | 2 |
| Air conditioning : | Yes |
| Energy efficiency : | A+ |
| Year of construction : | 2024 |

Price : 279.630 €

Apartments for sale in a new project under construction, Pula!

A new residential unit under construction, located in the immediate vicinity of the city center.

The 4-story building (basement + 3 floors) will have an elevator, garage spaces in the basement, and outdoor parking spaces around the building itself.

Apartment II-2 is located on the 2. st floor of the building, with a total square footage of 80.16 m² (netto78,77 m²), and consists of: hallway, kitchen, living room and dining room, pantry, 2 bedrooms, toilet, bathroom and loggia. Heating/cooling of the apartment will be provided with Mitsubishi air conditioners and underfloor heating.

A parking space is additionally purchased with the apartment, and there is also the possibility of purchasing a storage room in the basement of the building.

Completion of the works on the construction of this project is expected in the 6th month of 2025.

Note: The buyer does not pay real estate sales tax.

For more information, please

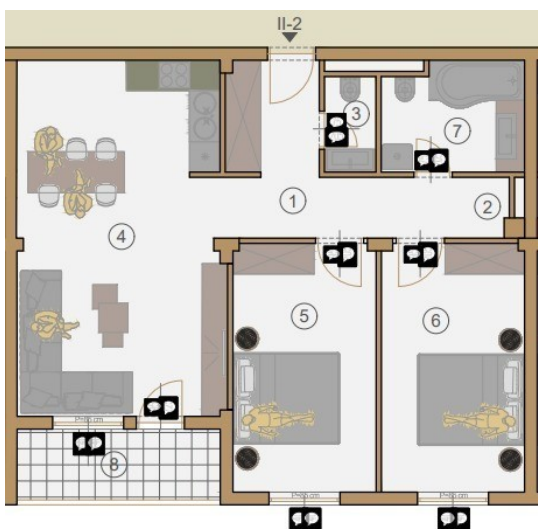

| STAN II-2 | | | | |
|---------------------------|-------------------|----------------------|-------|------------------------------|
| br. | naziv prostorije | netto m ² | koef. | netto x koef. m ² |
| 1 | Hodnik | 9,65 | 1 | 9.65 |
| 2 | Ostava | 1,07 | 1 | 1.07 |
| 3 | WC | 1,91 | 1 | 1.91 |
| 4 | Kuh.+blag.+dnevni | 28,49 | 1 | 28.49 |
| 5 | Soba | 13,77 | 1 | 13.77 |
| 6 | Soba | 13,77 | 1 | 13.77 |
| 7 | Kupaonica | 5,92 | 1 | 5.92 |
| STAN II-2 zatvoreno neto: | | 74,58 | | 74.58 |
| 8 | Loda | 5,58 | 0,75 | 4.19 |
| STAN II-2 ukupno neto: | | 80.16 | | 78.77 |

